



INSTALLATION INSTRUCTIONS FOR A2FHC CABLE GLAND

CABLE GLAND FOR USE WITH UNARMoured AND BRAID ARMoured CABLES

INCORPORATING EU DECLARATION OF CONFORMITY TO DIRECTIVE [2014/34/EU]

CABLE GLAND TYPE A2FHC



TECHNICAL DATA

CABLE GLAND TYPE : A2FHC
INGRESS PROTECTION : IP66, IP67, IP68
PROCESS CONTROL SYSTEM : BS EN ISO 9001
ISO/IEC 80079-34:2011

EXPLOSIVE ATMOSPHERES CLASSIFICATION

ATEX CERTIFICATION No : SIRAI3ATEX1068X, SIRAI3ATEX4074X,
ATEX CERTIFICATION CODE : Ex d IIC Gb, Ex e IIC Gb, Ex nR IIC Gc, Ex ta IIIC Da (Group II)
Ex d I Mb, Ex e I Mb (Group I)
IECEX CERTIFICATION No : IECEX SIR.13.0023X, IECEX SIM 14.0006
IECEX CERTIFICATION CODE : Ex d IIC Gb, Ex e IIC Gb, Ex nR IIC Gc, Ex ta IIIC Da (Group II)
Ex d I Mb, Ex e I Mb (Group I)
CSA CERTIFICATION No : 1211841
CSA CERTIFICATION CODE : Ex d IIC / Ex e II / Ex nR II, CSA Enclosure Type 4X

INSTALLATION INSTRUCTIONS

Installation should only be performed by a competent person using the correct tools. Spanners should be used for tightening. Read all instructions before beginning installation.

SPECIAL CONDITIONS FOR SAFE USE

None.

ACCESSORIES

The following accessories are available from CMP Products, as optional extras, to assist with fixing, sealing and earthing :-
Locknut, Earth Tag, Serrated Washer, Entry Thread (I.P) Sealing Washer, Shroud

Cable Gland Size	Hose Diameter	Standard Metric Entry Threads	Minimum Thread Length	Overall Cable Diameter		Across Flats	Across Corners	Protusion Length	Hose Connection Length	Combined Ordering Reference (*Brass Metric)			Shroud	Cable Gland Weight (Kgs)
				Min	Max					Max	Max	Size		
20S/16	13.0	M20	15.0	3.2	8.7	24.0	26.4	34.0	13.0	16	A2FHC13	1RA	PVC03	0.100
20S/16	16.0	M20	15.0	3.2	8.7	24.0	26.4	34.0	16.0	16	A2FHC16	1RA	PVC03	0.110
20S	16.0	M20	15.0	6.1	11.7	24.0	26.4	37.0	16.0	20S	A2FHC16	1RA	PVC03	0.090
20	19.0	M20	15.0	6.5	14.0	27.0	29.7	44.0	19.0	20	A2FHC19	1RA	PVC05	0.110
25	25.0	M25	15.0	11.1	20.0	36.0	39.6	53.0	25.0	25	A2FHC25	1RA	PVC08	0.210
32	32.0	M32	15.0	17.0	26.3	41.0	45.1	60.0	32.0	32	A2FHC32	1RA	PVC10	0.270
40	38.0	M40	15.0	23.5	32.2	50.0	55.0	69.0	38.0	40	A2FHC38	1RA	PVC12	0.380
50S	51.0	M50	15.0	31.0	38.2	55.0	60.5	83.0	51.0	50S	A2FHC51	1RA	PVC15	0.740
50	51.0	M50	15.0	35.6	44.0	60.0	66.0	84.0	51.0	50	A2FHC51	1RA	PVC17	0.570
63S	63.0	M63	15.0	41.5	49.9	70.5	77.6	100.0	63.0	63S	A2FHC63	1RA	PVC20	1.210
63	63.0	M63	15.0	47.2	55.9	75.0	84.0	100.0	63.0	63	A2FHC63	1RA	PVC22	0.860
75S	76.0	M75	15.0	54.0	61.9	80.0	88.0	123.5	76.0	75S	A2FHC76	1RA	PVC24	1.760
75	76.0	M75	15.0	61.1	67.9	85.0	93.5	123.5	76.0	75	A2FHC76	1RA	PVC26	1.260

*Note : For material options please add the following suffix to change the Ordering Reference ; Brass (no suffix required), Nickel Plated Brass "S", 316 Grade Stainless Steel "4", Copper Free Aluminium "1"
For NPT options please add the following digits to the material suffix ; 1/2" = 31, 3/4" = 32, 1" = 33, 1 1/4" = 34, 1 1/2" = 35, 2" = 36, 2 1/2" = 37, 3" = 38, 3 1/2" = 39 (Brass requires prefix "0")

Examples : 32A2FHC321RA534 = Nickel Plated Brass 1-1/4" NPT, 50SA2FHC511RA035 = Brass 1-1/2" NPT, 25A2FHC251RA432 = Stainless Steel 3/4" NPT, 20A2FHC191RA5 = Nickel Plated Brass M20

Dimensions are displayed in millimetres unless otherwise stated

Note: Standard Seal (Black) Temperature Range = -60°C to +130°C,

High Temperature Seal (Brown) Temperature Range = -20°C to +200°C for High Temperature Seal add 'HT' to Ordering Reference after Gland Type e.g. 20SA2FHC16HT1RA.

CMP Products Ltd. on its sole responsibility declares that the equipment referred to herein conforms to the requirements of the ATEX Directive 2014/34/EU and the following standards: -

EN60079-0:2012, EN60079-1:2007, EN60079-7:2007, EN60079-15:2010, EN60079-31:2009, BS6121:1989, EN62444:2013

David Willcock – Certification Engineer (Authorised Person)
CMP Products Limited, Cramlington, NE23 1WH, UK
24th June 2015

CE 0518

Glasshouse Street • St. Peters • Newcastle upon Tyne • NE6 1BS

Tel: +44 191 265 7411 • Fax: +44 1670 715 646

E-Mail: customerservices@cmp-products.co.uk • Web: www.cmp-products.com



Notified Body: Sira Certification Service, Unit 6 Hawarden Industrial Park, Hawarden, CH5 3US, UK

www.cmp-products.com



Logo's shown for illustration purposes only. Please check certification for details

INSTALLATION INSTRUCTIONS FOR CMP CABLE GLAND TYPES A2FHC

CABLE GLAND COMPONENTS - It is not necessary to dismantled the cable gland any further than illustrated below

- 1. Entry Item
- 2. Seal
- 3. Seal Nut with hose connection

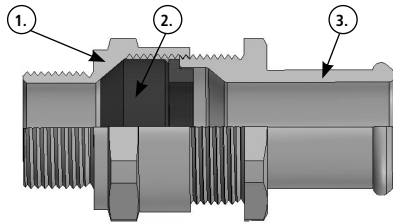

PLEASE READ ALL INSTRUCTIONS CAREFULLY BEFORE BEGINNING THE INSTALLATION

1. It is not necessary to dismantle the gland any further than illustrated below.

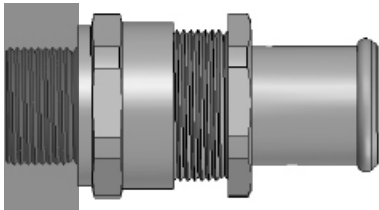

2. Fit the gland into the equipment and fully tighten the entry item (1).

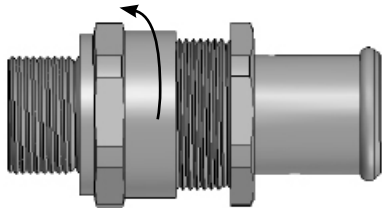

3. Determine the conductor length required to suit the installation and prepare the cable accordingly, removing part of the outer sheath where required to reveal the insulated conductors.



4. Slacken the seal nut (3) to relax the seal (2).

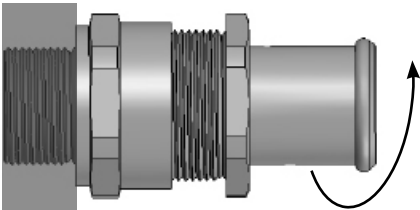

5. Pass the cable through the gland to the desired position, then tighten the seal nut by hand until resistance is felt (when the seal contacts the cable). Tighten with a spanner one further turn.

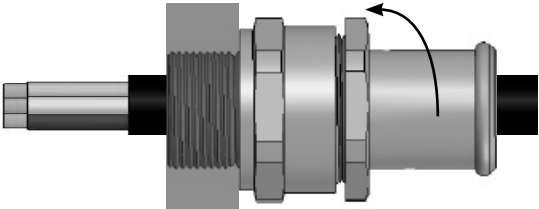

6. Fit a jubilee clip over the end of the hose. Attach the hose to the hose connection and tighten the jubilee clip to secure.

