

# OLYMPUS-S (SHVSS-S)

## High Voltage, Stainless Steel, Single Formation Cable Cleat

CMP OLYMPUS-S single cable cleat is a composite cable cleat which has been designed, constructed and tested in accordance with the International Standard 'cable cleats for electrical installations' IEC 61914 to ensure the securing and retention of cables, without sustaining damage. The S version of this product is designed to be used with smaller cables of size 50mm up to 110mm diameter. For larger cables please see the Olympus SHVSS product range.

The stainless steel section of this cable cleat can be optionally coated with a high performance thermoplastic coating which is UL94 VO flame retardant. This low toxicity polymer alloy coating is halogen free and low smoke & fume, whilst being resistant to: impact, abrasion, salt spray, chemical attack, weathering & UV, making it perfectly suited for use in rail applications.

OLYMPUS-S cable cleats are designed to be installed as a system for use with High Voltage cable installations and can be manufactured in a standard set of cable diameter ranges or to suit specific project parameters.

Fabricated in non-magnetic 316L stainless steel, giving it high creep strength whilst providing excellent corrosion resistance in the harshest environments.

Flame retardant low smoke and fume, zero halogen (FR LSF/LSOH) polymeric fixed liners are fitted as standard, helping to:

- Restrain the cables within vertical applications.
- Provide a layer of protection to both the cable sheath and the cable cleat, during normal operation where thermal elongation of cable occurs.
- Protect the cable from chafing on any mounting surface due to differential movements, such as those found in marine and offshore applications.
- Assist in the extra protection of cables in the event of short circuit fault conditions.



### TECHNICAL DATA & CLASSIFICATION

TYPE	6.1.3 Composite
DESIGN SPECIFICATION	IEC 61914
TEMPERATURE FOR PERMANENT APPLICATION	-60°C to +90°C IEC 61914 clause 6.2
NEEDLE FLAME TEST	Pass - 120 seconds IEC 61914 clause 10.0, 10.1, IEC 60695-11-5
IMPACT RESISTANCE	Pass - Very Heavy IEC 61914 clause 6.3, 6.3.5, 9.2
MATERIAL	316L Stainless Steel
MATERIAL THICKNESS	2mm
LINER MATERIAL	FR LSF / LSOH Polymer
CABLE FORMATION	Parallel / Single / Multicore

### SHORT CIRCUIT TESTING TO IEC 61914 - CLAUSE 9.5

FLAT/PARALLEL FORMATION		
ONE SHORT CIRCUIT 600mm FIXED CLEAT CENTRES	TWO SHORT CIRCUIT 600mm FIXED CLEAT CENTRES	ONE SHORT CIRCUIT 600mm FIXED CLEAT CENTRES
1 sec	1 sec	0.6 sec
Conductor Centres 154mm	Conductor Centres 154mm	Conductor Centres 154mm
132 kA Peak	131 kA Peak	141 kA Peak
60 kA r.m.s	59.5 r.m.s	64 kA r.m.s

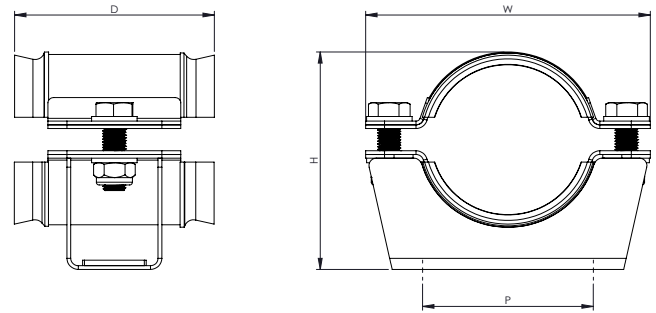

### FEATURES

- Third party certified to IEC 61914
- 316L Stainless Steel
- Operating temperature -60°C to +90°C
- Excellent axial and lateral load retention

### CABLE CLEAT SELECTION TABLE

PART NUMBER	CABLE Ø RANGE TAKE (mm)	DIMENSIONS (mm)					WEIGHT (g)
		W	H	D	P	FIXING HOLE Ø	
SHVSS050060-S	50-60	130	97	100	90	2 x M12	1004
SHVSS060070-S	60-70	140	108	100	90	2 x M12	1062
SHVSS070080-S	70-80	150	118	100	90	2 x M12	1125
SHVSS080090-S	80-90	160	128	100	90	2 x M12	1186
SHVSS090100-S	90-100	170	138	100	90	2 x M12	1249
SHVSS100110-S	100-110	180	148	100	90	2 x M12	1284